

FIRST LEVEL FLOOR FRAMING PLAN
 1/8" = 1'-0"

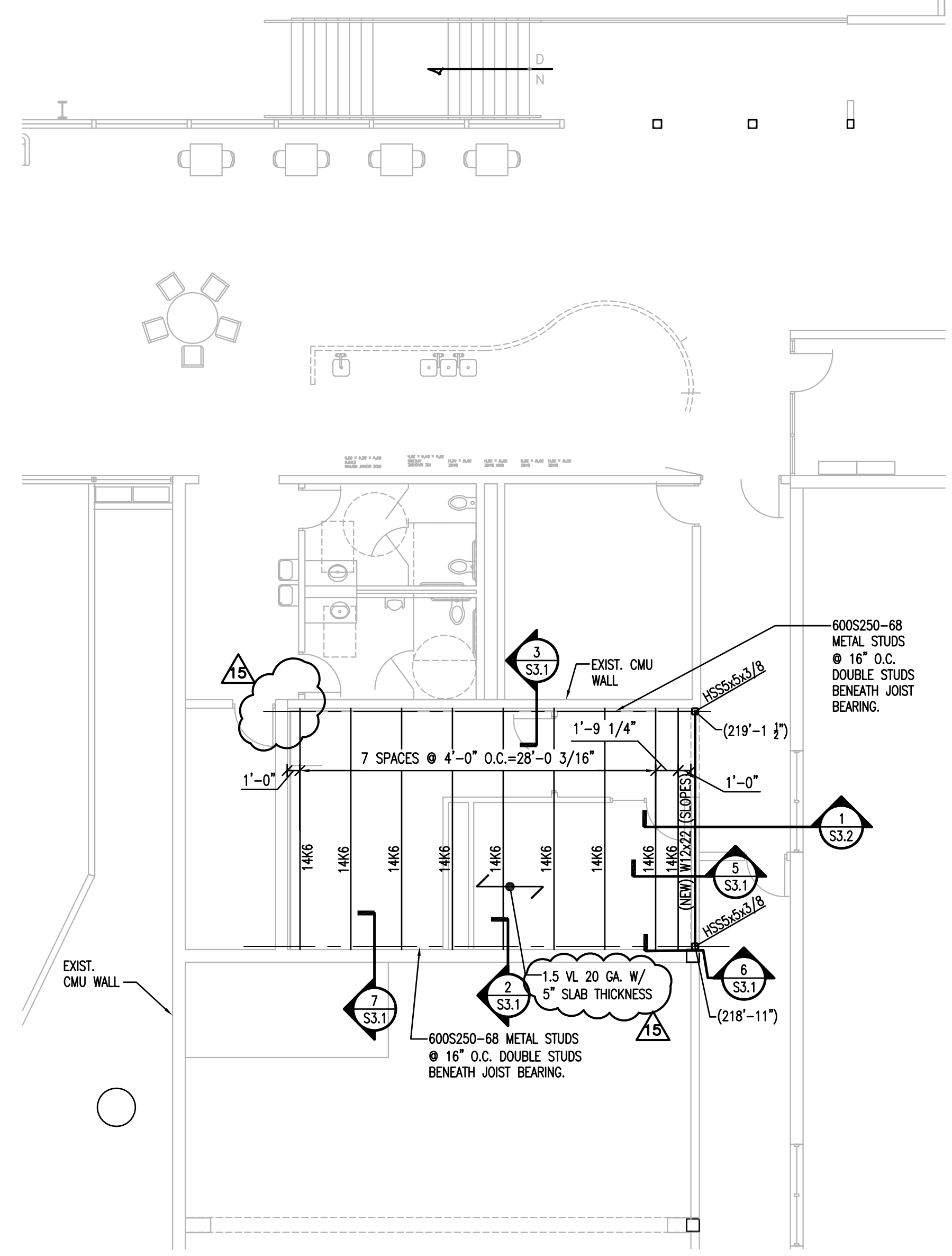

FIRST LEVEL FLOOR FRAMING PLAN (ALTERNATE #1)
 1/8" = 1'-0"

- PLAN NOTES:**
- TOP OF STEEL IS 208'-6 1/2" UNLESS NOTED OTHERWISE.
 - 5" TOTAL THICKNESS CONCRETE SLAB ON 1 1/2" VL 20 GA. COMPOSITE GALVANIZED STEEL DECKING TOPPED WITH 145 PCF 4,000 PSI NORMAL WEIGHT CONCRETE WITH 6x6-W1.4xW1.4 WELDED WIRE FABRIC REINFORCING. TOP OF SLAB ELEVATION IS 114'-0".
 - THE BEAM DESIGNATIONS SHOWN ON THE DRAWINGS SHALL BE READ AS FOLLOWS:

- W12x14 (12) c=2" CAMBER AT CENTERLINE OF BEAM IN 1/4" OF AN INCH INCREMENTS. WHEN NO NUMBER IS GIVEN, NO CAMBER IS REQUIRED FOR THAT BEAM.
- NUMBER OF ASTM A108 TYPE B 3/4" DIAMETER BY 4 1/2" LONG HEADED SHEAR STUDS REQUIRED TO BE WELDED DIRECTLY TO THE TOP FLANGE OF THE BEAM. SHEAR STUDS SHALL BE EVENLY SPACED U.N.O. STUDS SHALL BE SPACED IN ACCORDANCE WITH A.I.S.C. REQUIREMENTS AND SHALL BE PLACED ON CENTERLINE OF BEAM UNLESS SPACING IS LESS THAN MINIMUM ALLOWED BY A.I.S.C. IN THOSE CASES ROWS OF 2 OR 3 STUDS SHALL BE USED. WHEN NO NUMBER IS GIVEN, SHEAR STUDS ARE NOT REQUIRED FOR THAT BEAM.
- STANDARD A.I.S.C. BEAM DESIGNATION

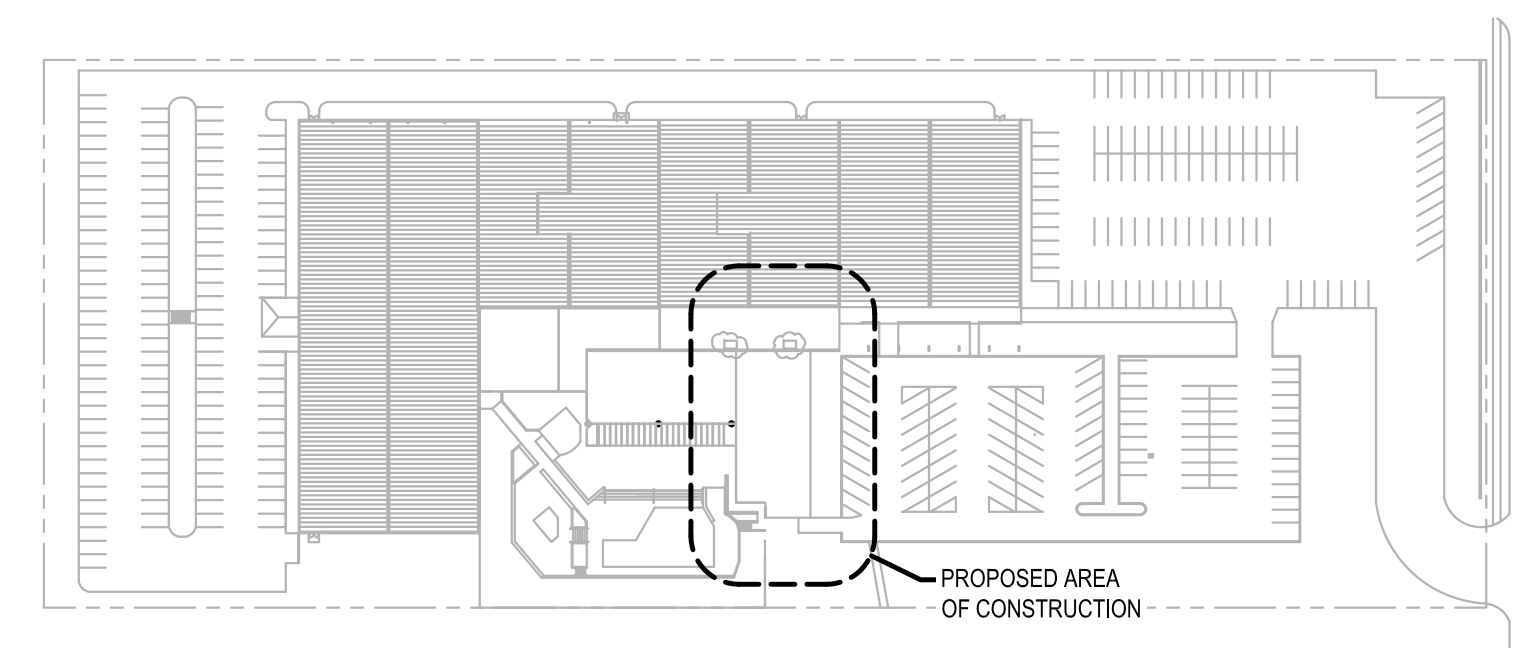

KEY PLAN
 N.T.S.

PERFORMANCE Engineering
 11811 Ford Street, Suite 104 - Omaha, NE 68164
 389 Perry St., Suite 204A - Casper Rock, CO 80704
 Phone: (402) 343-3980 Fax: (402) 343-3981
 PE #: 181126

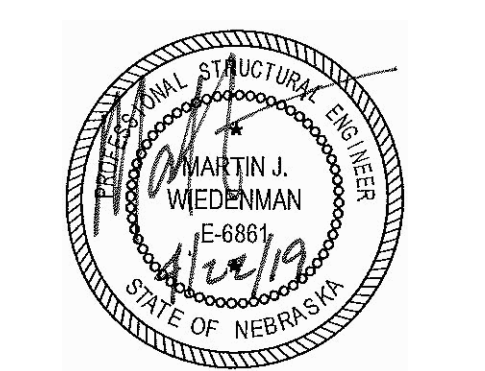

HANNEY & ASSOCIATES, ARCHITECTS
 1726 South Hillside, Wichita, Kansas, 67211
 Phone: (316) 683-8965 Fax: (316) 684-1441

2019 GENESIS HEALTH CLUBS WESTROADS
 1212 NORTH 102ND STREET
 OMAHA, NE 68114



DRAWINGS ISSUED			
NO.	DATE	ITEM	ISSUED
15	10/10/19	ADDENDUM #3	
14	04/22/19	ISSUED FOR BID	
13	02/18/19	REVIEW	
12	01/24/19	REVIEW	
11	01/08/19	REVISIONS	
10	12/19/18	REVIEW	
9	11/27/18	REVIEW	

COMPUTER DRAWING
 S2-LDWS

DATE: APRIL 2019
 DRAWN BY: SLM CHECKED BY: MJM

SHEET
S2.1
 OF - SHEETS