

2019 OXFORD ELEMENTARY SCHOOL UNIFIED SCHOOL DISTRICT 358

319 East College Street, Oxford, Kansas 67119

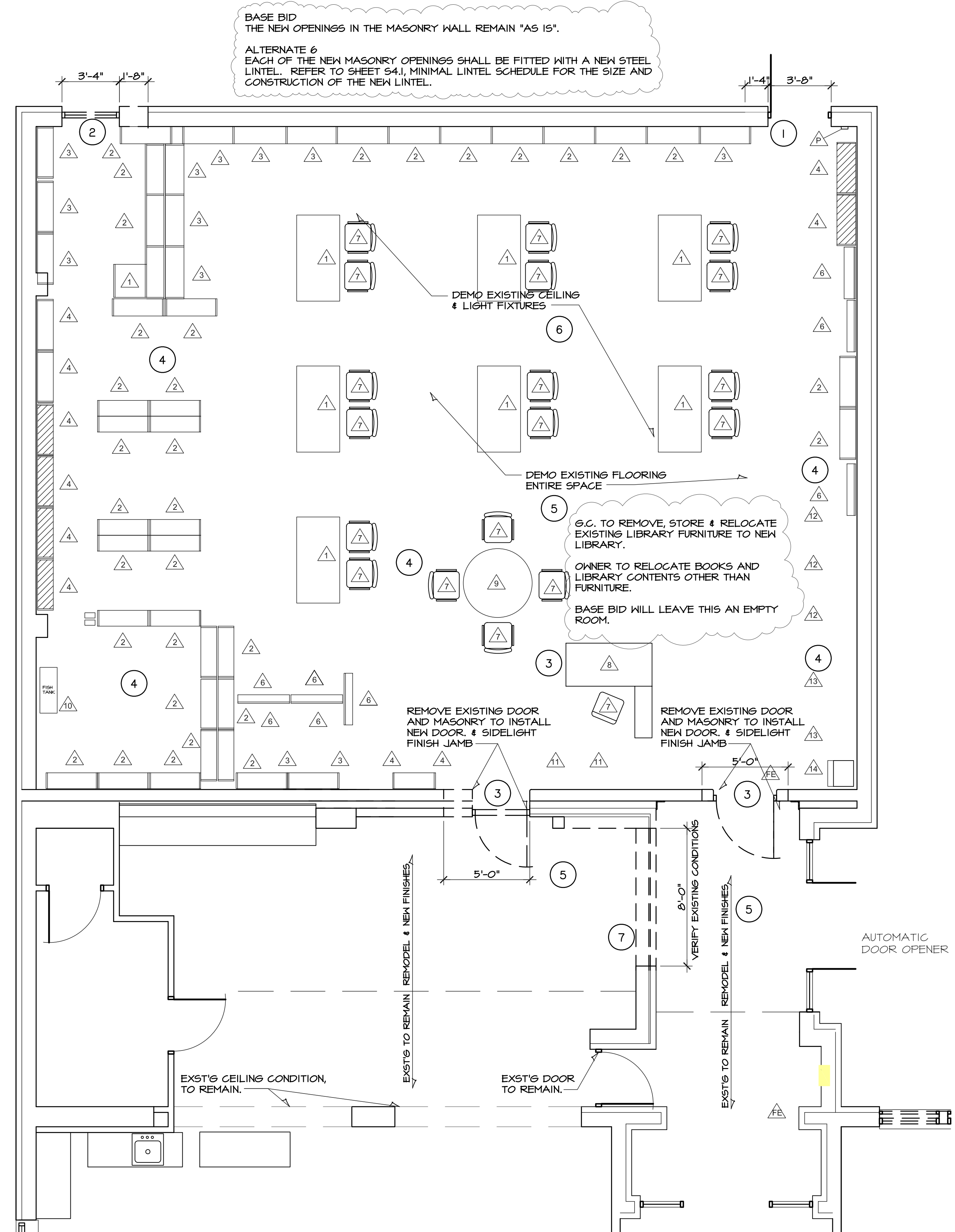

FURNITURE SCHEDULE		
	STUDENT TABLE	2'-6" x 3'-0"
	2 ROW BOOK SHELF	3'-0" TALL x 3'-0" LONG
	4 ROW BOOK SHELF	5'-0" TALL x 3'-0" LONG
	5 ROW BOOK SHELF	6'-0" TALL x 3'-0" WIDE
	WOOD BOOK SHELF	7'-0" TALL x 7'-0" WIDE
	MAGAZINE SHELF	
	CHAIR	
	LIBRARIANS DESK	
	ROUND TABLE	
	FISH TANK	
	2 ROW BOOK SHELF	2'-6" TALL x 3'-0" LONG
	WOOD CABINETS (WOOD DOORS)	7'-4" TALL x 3'-0" LONG
	WOOD CABINETS (GLASS DOORS)	7'-4" TALL x 3'-0" LONG
	WOOD CABINETS (GLASS DOORS)	7'-4" TALL x 1'-6" LONG

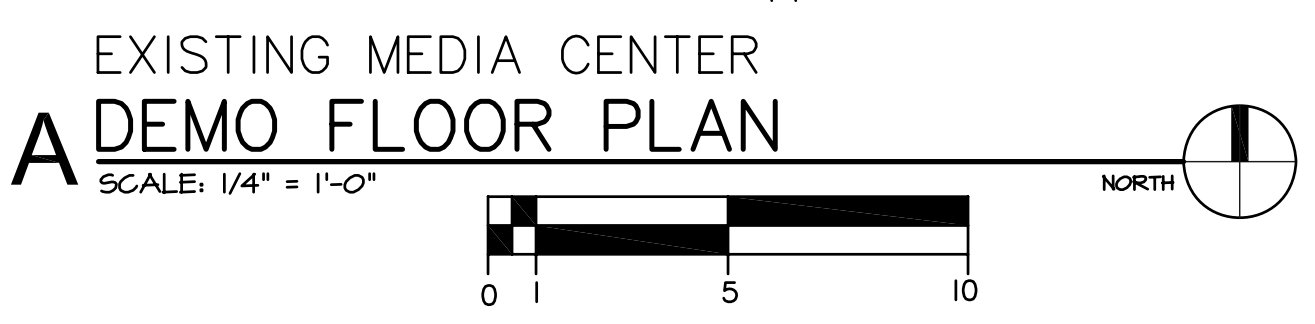

ALTERNATE 6 DEMO NOTES:

- REMOVE THE EXISTING WINDOW AND MASONRY TO INSTALL NEW EGRESS DOOR. FINISH JAMB BY TOOTHING SALVAGED BRICK.
- REMOVE THE EXISTING DOOR AND MASONRY TO INSTALL NEW EGRESS DOOR. FINISH JAMB BY TOOTHING SALVAGED BRICK.
- REMOVE EXISTING DOOR AND MASONRY TO INSTALL NEW DOOR. & SIDELIGHT. FINISH JAMB
- G.C. TO REMOVE, STORE & RELOCATE EXST'G LIBRARY FURNITURE TO NEW LIBRARY. OWNER TO RELOCATE BOOKS AND LIBRARY CONTENTS OTHER THAN FURNITURE.
- DEMO EXISTING FLOORING AND RELATED MASTIC AS REQUIRED FOR SMOOTH ADHESION OF NEW FLOORING.
- DEMO EXISTING CEILING AND LIGHTING FIXTURES.
- DEMO EXISTING BRICK AND CMU WALL AS REQUIRED TO CREATE NEW HALL AREA.

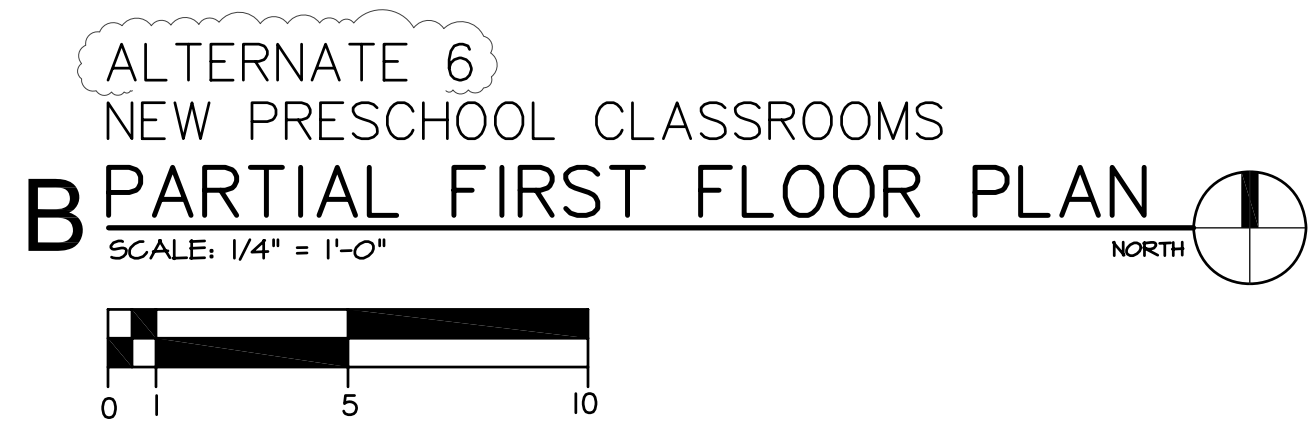
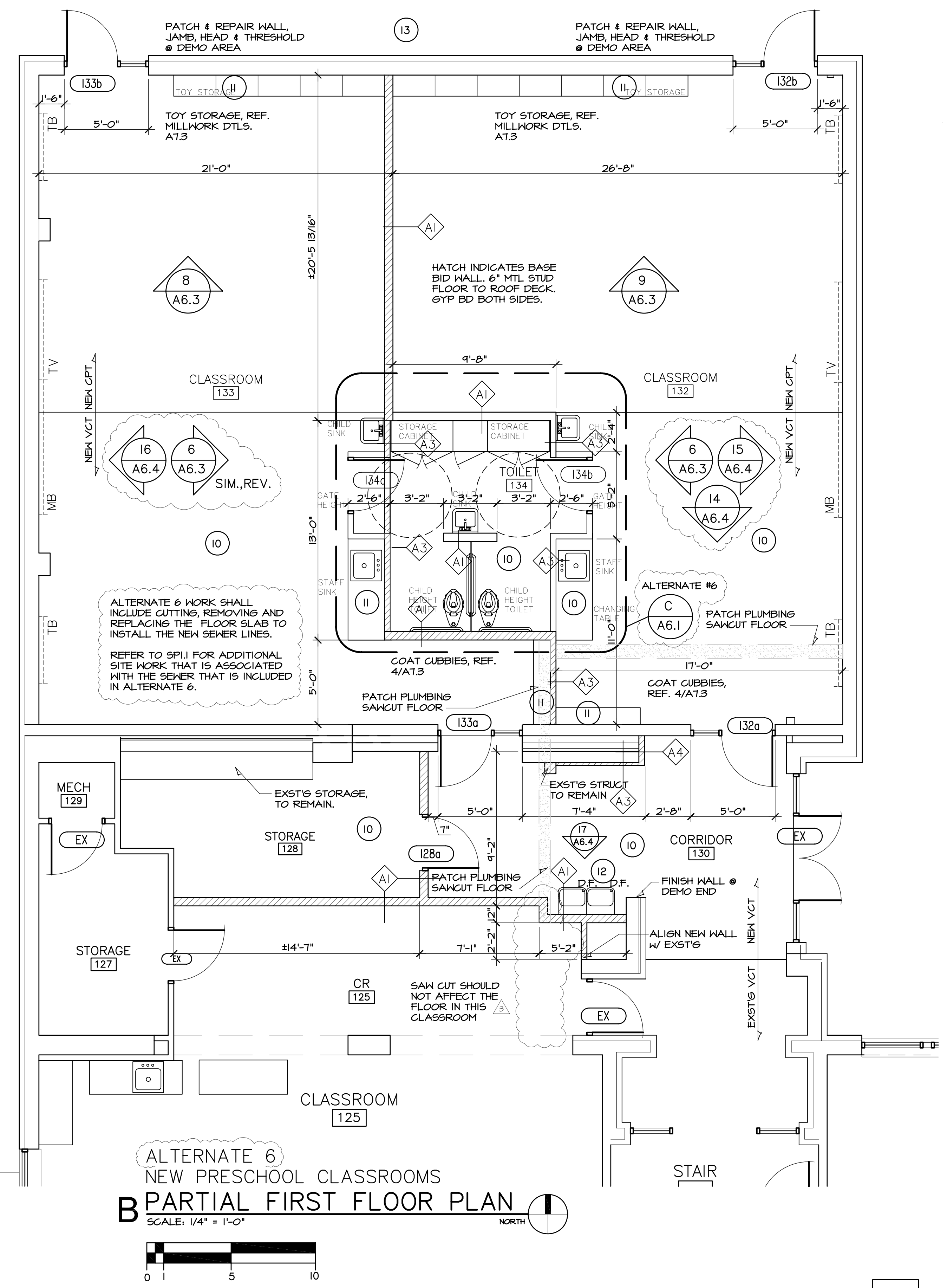

PLAN NOTES:

- NEW CEILING, & LAY IN LIGHTS, REF REFLECTED CEILING PLAN & ELEC.
- MILLWORK, BY G.C.
- NEW STAINLESS STEEL DRINKING FOUNTAINS, HI/LOW
- CLEAN EXISTING EXTERIOR MASONRY WALL

DRAWINGS ISSUED		
NO.	DATE	ITEM ISSUED
4	1/18/19	ADDENDUM 4
8	1/22/19	ADDENDUM 3
7	8/19/19	ISSUED FOR BIDS
6	8/1/19	FOR REVIEW
5	7/5/19	REVIEW
4	6/24/19	REVIEW
3	5/6/19	REVIEW
2	4/27/19	REVIEW
1	4/10/19	REVIEW

COMPUTER DRAWING
358B_ELEM_A104.dwg

DATE: AUGUST, 2019
DRAWN BY: MRH, CH, MB, JC
CHECKED BY: MRH

SHEET

A1.4

OF 1 SHEETS

