

KEY	
■	20 AMP CIRCUIT - WALL MOUNTED
■	15 AMP CIRCUIT - WALL MOUNTED
▨	15 AMP CIRCUIT - FLOOR MOUNTED

GENERAL NOTES	
G.C. IS TO INCLUDE IN BASE BID ALL NEW OUTLETS, CONDUIT AND BOXES ASSOCIATED WITH THE A/V EQUIPMENT.	
AUDITORIUM A/V EQUIPMENT AND STAGE LIGHTING ARE BEING BID OUT AS A SEPARATE CONTRACT. G.C. IS TO COORDINATE.	
ELECTRICAL SUB-CONTRACTOR AND GENERAL CONTRACTOR ARE TO COORDINATE WITH STAGE A/V SUPPLIER ON FINAL LOCATIONS OF ALL EQUIPMENT PRIOR TO INSTALL.	
CONDUIT TO AMPLIFIER RACK IS TO BE RUN ON THE BACK SIDE OF THE PROSCENIUM OPENING AND ABOVE THE CEILING. CONCEAL AS MUCH AS POSSIBLE.	
STAGE FLOOR AND FACE INSTALLS ARE TO HAVE CONDUIT ROUTED UNDERNEATH STAGE FLOOR AS MUCH AS POSSIBLE. TURN UP CONDUIT AT STAGE WING WALLS TO AMP RACK.	

BASE BID - ELECTRICAL & CONDUITS
A AUDITORIUM A/V ELECTRICAL LOCATIONS
 SCALE: 1/8" = 1'-0"

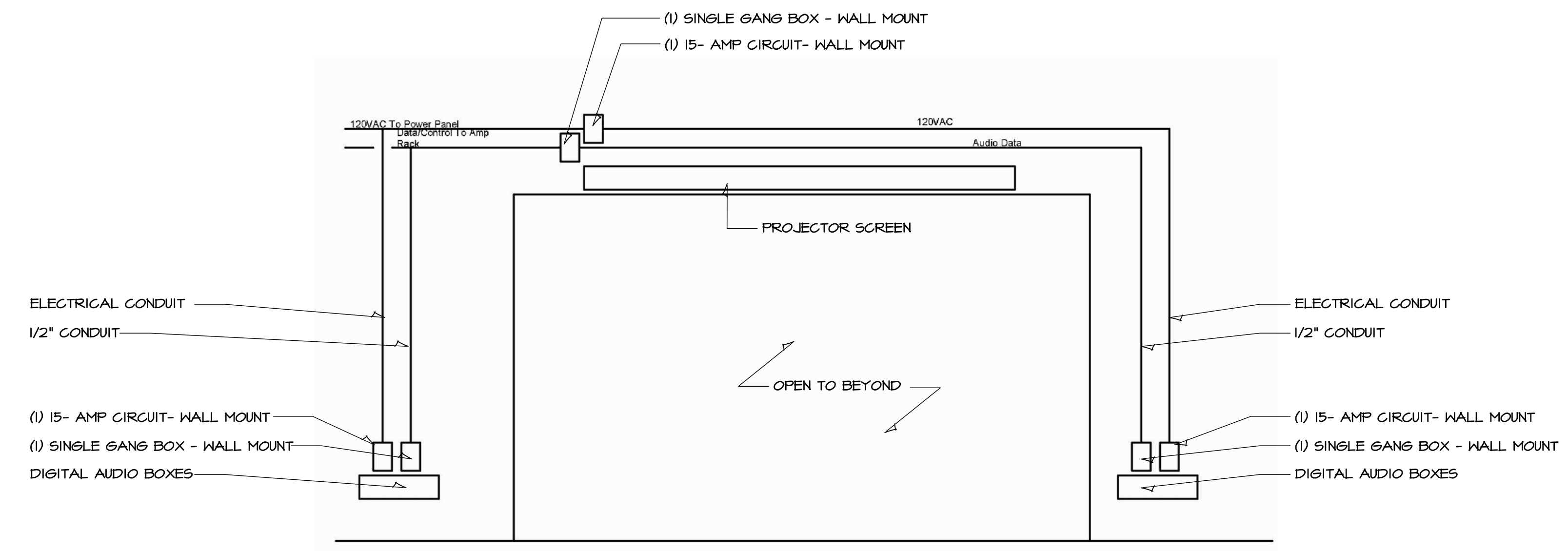

BASE BID - ELECTRICAL & CONDUITS
B ELEVATION - BACK OF PROSCENIUM OPENING
 SCALE: 1/8" = 1'-0"

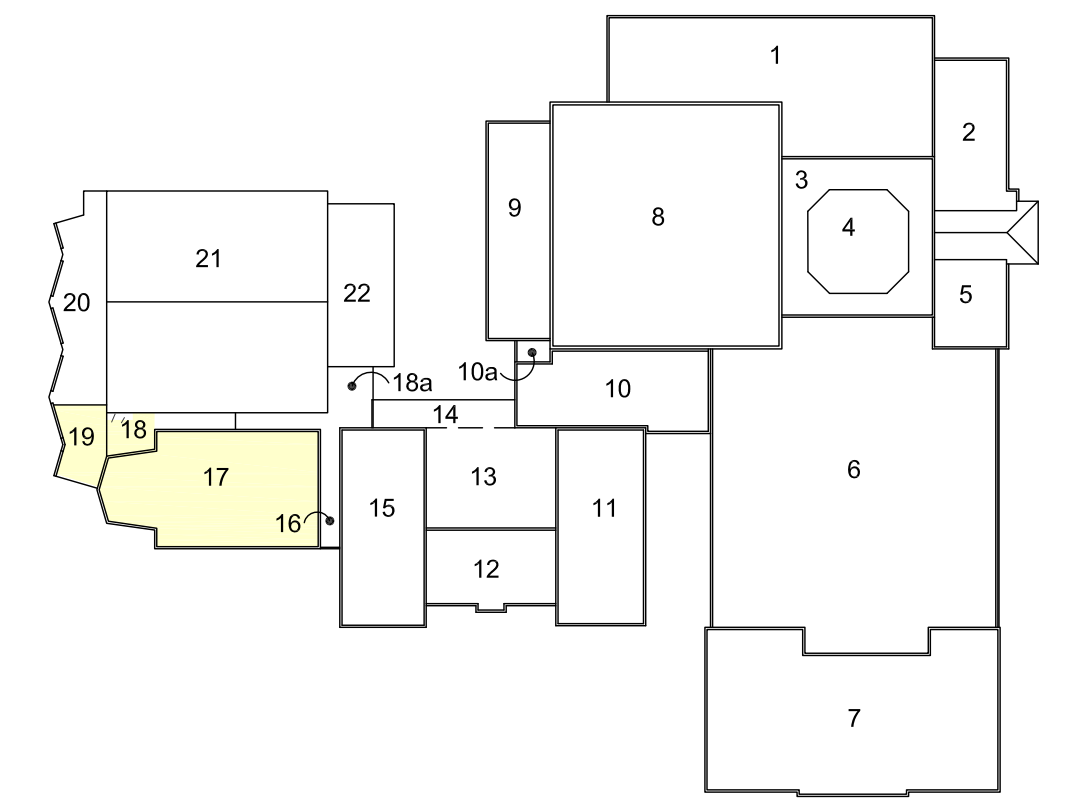

KEY PLAN

DRAWINGS ISSUED		
NO.	DATE	ITEM ISSUED
1	2/6/20	ADDENDUM 6

COMPUTER DRAWING

DATE: AUGUST, 2019	CHECKED BY:
DRAWN BY: MH, CH, MB, JC	MRH

SHEET

A2.14

OF 1 SHEETS