

Addendum Number Two

To the Drawings and Specifications for:
24/7 Travel Store, Goodland, Kansas

Issued: Thursday, September 18, 2020

HANNEY & ASSOCIATES ARCHITECTS

1726 South Hillside, Wichita, Kansas

NOTICE TO BIDDERS:

You are hereby instructed to include in your bids the following changes, clarification and/or corrections to the Drawings and Specifications for **24/7 Travel Store, Goodland, Kansas**.

The additions and/or corrections shall be considered as a part of the Contract Documents as if incorporated therein. Where the following corrections and/or additions vary from the conditions of the Drawings and Specifications, such following changes or additions shall govern.

I. GENERAL CLARIFICATIONS:

- 1.1 Bid Date
The Bid Date is unchanged and remains Thursday, September 24, 2020.
The time and location to receive the bids remains unchanged.
- 1.2 Construction Start Date
Construction to begin "As Soon As Possible".
- 1.3 Storm Water Pollution Prevention Plan (SWPP Plan)
The SWPP Plan from the first set of plans is still valid with the updated drawings.
To adjust for the new drawings, move 20" of Bio-log to the northwest corner of the site, toward the west, in from of the flume. SWPP should be installed all at once, vs. a phased installation.
- 1.4 Signs
All signs will be procured by Owner and installed by Owner. General Contractor will need to assist with coordinating field dimensions to be compliant with the ADA, and to provide electrical as where required.
- 1.5 Temporary Construction Fence
The temporary construction fence shall be sufficient to secure the building construction from the occupied space, to keep the store patrons safe and to provide adequate room for the construction. The fence may have to be moved at times to accommodate the construction as the project develops.
- 1.6 Dog Park - Shade Canopy
There is no work for the General Contractor for Dog Park Shade Canopies in the Base Bid. The reference to the General providing the footings shall be deleted.

- 1.7 Dog Park – Trash Cans and Picnic Tables
The trash cans and picnic tables shall be provided and installed by the General Contractor in the Base Bid. Please refer to Sheet AS1.3.
- 1.8 Landscaping
The landscape and grass seeding shall be by the Owner.
Fine grading and restoration of the disturbed areas shall be by the General Contractor.
- 1.9 Existing Tank Farm
- A. There are four existing underground fuel tanks. The sizes are 12,000 gallon, 10,000 gallon, and two (2) 15,000-gallon tanks.
 - B. The Petroleum Contractor (separate contract with the Owner) will take care of disconnection, emptying and purging the existing tanks and lines prior to removal.
 - C. The Petroleum Contractor (separate contract with the Owner) will remove the North Gasoline dispenser and cap lines to prepare for the construction of the new gasoline islands. The General Contractor will demo the North part of the existing gasoline canopy, stabilizing the remaining canopy for continued use by customers.
 - D. KDHE will be on-site and will test the existing tank farm soils for contamination.
- 1.10 Soils Stabilization
There are various references in the documents to fly ash soil stabilization. The Geotech Engineer has noted in the soils report that the on-site material is good and can be used on-site. As such, all references to fly ash stabilization shall be changed (deleted) to comply with the soils report; specifically, soils below the building shall comply with paragraph 5.4, and soils below the pavement shall comply with paragraph 5.5.1.
- 1.11 Sales Tax
As noted in Addendum One, this project is Sales Tax exempt, from both labor and materials.
- 1.12 Shop Drawings
Shop Drawings can be submitted electronically.
- 1.13 Products or manufacturers approved as “Equals” shall meet all requirements of the plans, specifications, standards of performance and construction, as established by the product or manufacturer originally specified.
- 1.14 Landfill Costs
Sherman County has waived the landfill costs for everything except fuel tanks and contaminated soil. Also, please refer to item 2.2 of this addendum.

1.15 Concrete Salt Guard

Areas of the concrete shall be protected with Salt Guard as manufactured by Carter-Waters. This coating is called out on Sheet AS1.1, and in the specifications Section 03300-Concrete. The scope of the Salt Guard installation shall be as shown in orange on the sketch below:

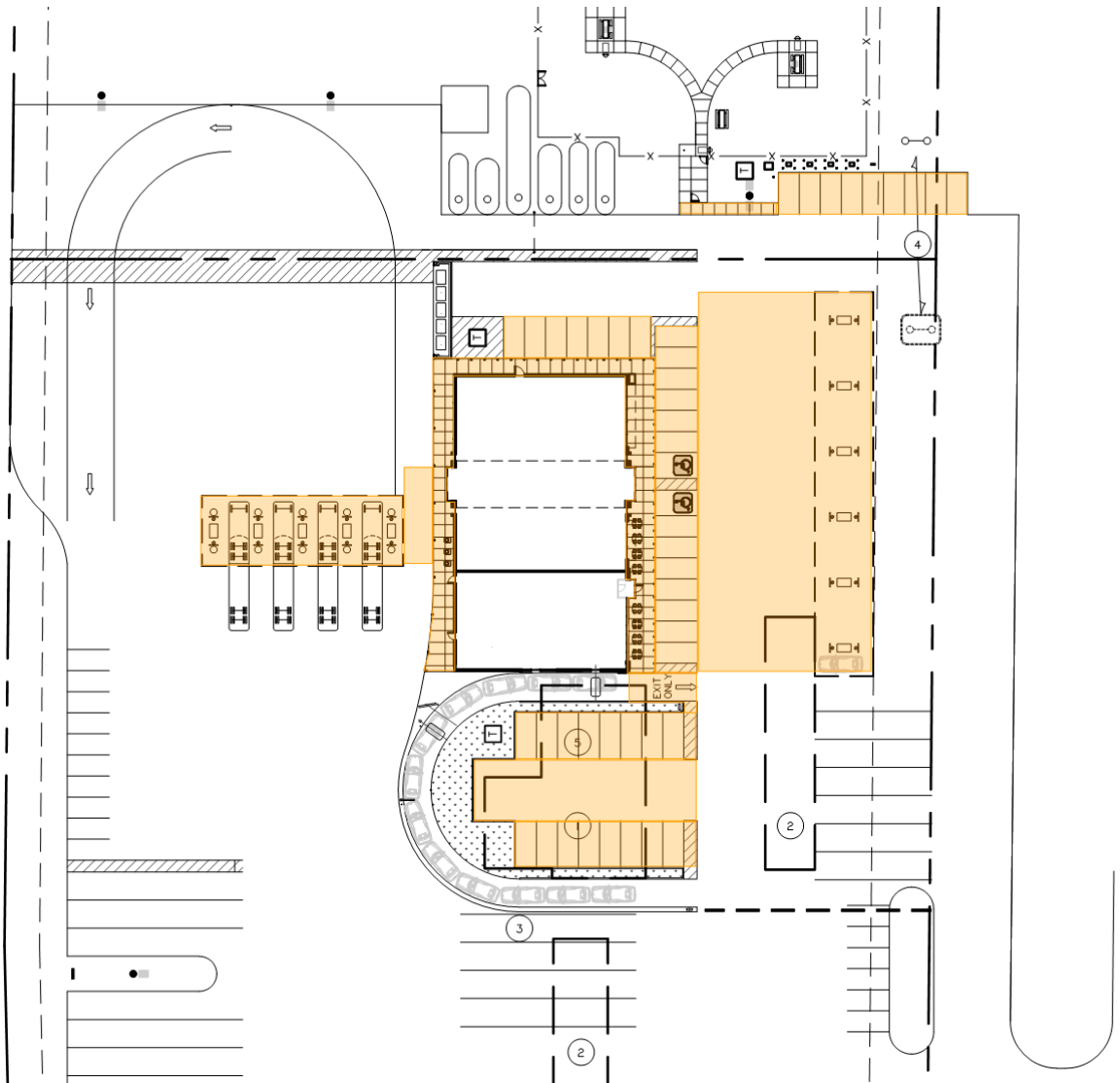

1.16 Petroleum Excavation and Trenching

- a. The excavator, contracted by the General Contractor, is to provide the backfill, tele-belt, and loader for the new tank field. Petroleum Contractor (separately contracted by the Owner) will set the tanks, dead-man and manage the fill in the tank hole.
- b. The petroleum trenches are as follows: Gasoline to be 4-feet wide, Diesel to be 2-feet wide.

- 1.17 Pre-Fabricated Canopy above Qdoba / Caribou Windows
These canopies are to be provided and installed by the General Contractor.
The canopy shall be finished with “Sunbrella Awning Fabric”. Verify color with Architect prior to ordering.
- 1.18 Car Charging Stations
The Alternate #1 – Car Charging Stations shall be clarified.
Refer to AS1.6, the Owner will provide the three (3) quick charge electric charging stations equipment, and the vehicle charging station power engine cabinet (Item 16) that comes with them. The General Contractor will still be responsible for concrete pads and overall installation; the Electrical Subcontractor will provide circuit, conduit and power as detailed on E2.1.
- 1.19 Qdoba Kitchen Equipment Responsibilities
Refer to “General Notes” on Sheet “QK1.0” and “equipment schedule” on Sheet “QK3.0” for responsibilities associated with Qdoba kitchen equipment. Items defined as “KEC” are provided and installed by Owner under separate contract. The Owner will store the equipment and deliver said equipment to the job site when the General Contractor is ready for the installation to occur.
- 1.20 Qdoba Lighting
Specialty lighting in the Qdoba Tenant Space (pendant fixtures centered above tables, and chandelier fixture) are provided by the Owner under a separate FFE contract. The Electrical Contractor for the General Contractor shall provide power, and install the Qdoba lighting.

II. CHANGES TO SPECIFICATIONS:

- 2.1 Section 00300 – Special Conditions
- a. The following paragraph shall be added:
BONDING (Performance and Labor and Materials)
Bonding is not required if the General Contractor submits a Lien Release with paid receipts with each Pay Application.
 - b. TAXES, Paragraph 39
The paragraph shall be clarified to include: The sales tax exemption applies to both labor and materials.
 - c. BUILDERS’ RISK INSURANCE, Paragraph 49
Shall be modified to remove the requirement for the deductible (with the striken-thru text being removed). The Owner will be responsible for providing the Builders’ Risk policy and for paying the cost of any deductible.

~~The deductible for the Owner’s coverage is \$10,000. The General Contractor shall be responsible for paying the deductible on a claim.~~

- 2.2 Section 02050 – Preparation of Site
 - a. The following paragraphs shall be added to Paragraph 5:
 - 1. The Sherman County Commission has approved waiving the landfill costs for demolition debris removal, with the exception of fuel tanks and contaminated soil, which cannot be disposed of at the Landfill.

- 2.3 Section 03300 – Concrete
 - Paragraph 1.7 Protection and Curing, item
 - a. Paragraph 19 – Joints in Concrete, Item 19.7 Salt Guard.
This product is made by Carter-Waters, and is used by 24-7 Travel Stores at all their facilities. The application of the Salt Guard shall be per the manufacturer’s recommendation. Refer to Item 1.14 in this Addendum for an illustration of the areas to receive the treatment.

- 2.4 Section 04200 – Masonry
 - a. Paragraph “D” shall be clarified. Glen-Gery purchased Sioux City Brick, the color, size, and finish shall remain as shown.

 - b. Paragraph “E” shall be clarified to list the address for Glen-Gery, as follows: 504 F Street, sergeant Bluff, Iowa 51054, (712) 943-5581 phone.

- 2.5 Section 08170 – Door Hardware
 - a. Hardware Sets #3, change the opening 205 to be 211b.

 - b. Hardware Sets #8, add opening 211a.

 - c. Hardware Sets #12, add opening 209.

- 2.6 Section 08582 – Pass-Thru Windows
“Quikserv” is an approved manufacturer of Pass-Thru Windows, for this project.

III. CHANGES TO DRAWINGS:

- 3.1 Sheet AS1.1
The Storage Bio-Pump Shed shown just West of the Dog Park is not included in this contract.

- 3.2 Sheet AS1.3
The Storage Bio-Pump Shed shown just West of the Dog Park is not included in this contract.

- 3.3 Sheet AS1.7
Elevation 4, the twelve (12) steel pipe bollards shown inside the trash coral, along the East wall, are to be deleted. The four (4) steel pipe bollards shown protecting the masonry end piers are to remain.

- 3.4 Sheet A2.3
The Roof Plan has been updated to show the lighting for the red gable. The revised sheet can be downloaded from our web site www.haarchitects.com; then click on the “Shortcut to Plan Room” link.
- 3.5 Sheet A2.7
This is a new sheet that was prepared to show the roof details for the gable lighting. This new sheet can be downloaded from our web site www.haarchitects.com; then click on the “Shortcut to Plan Room” link.
- 3.6 Sheet A3.1
Door Schedule, Opening 201, the Hardware Set shall be corrected to read “Set 4”.
- 3.7 Sheet A4.1
- a. North Elevation, add the following note:
“Qdoba”, “Caribou Coffee” and “Dog Park” signs on the North Elevation are provided and installed by the Owner. The General Contractor shall provide power.
 - b. East and West Elevations, the canopy over the main entrance that is noted as “fabricated by G.C.”, the finish shall be silver metallic or clear anodized aluminum finish.
- 3.8 Sheet A6.1
The door and entry to the Shelter / Family Restroom has been revised along with the walls at the sinks to facilitate the specified combination soap, water, hand dryer units. The revised drawing is available for download from our web site www.haarchitects.com; then click on the “Shortcut to Plan Room” link.
- 3.9 Sheet E1.1
The following shall be an acceptable alternate light fixture for fixture type ‘K1’:
Eurofase Lighting #P454C-05-CHROME.
Contractor shall provide all parts/components for complete working track lighting system with respect to the lengths and heads shown on the lighting plans.
Note: Revised specification on Special Outlet ‘P’. The revised drawing is available for download from our web site www.haarchitects.com; then click on the “Shortcut to Plan Room” link.
- 3.10 Sheet E1.6
Revised panel schedules and lighting contractor schedule, for added signage circuits for the Qdoba tenant location. The revised drawing is available for download from our web site www.haarchitects.com; then click on the “Shortcut to Plan Room” link.

- 3.11 Sheet E3.1
Revised lighting layout and added junction boxes/circuits associated with building signage on the east elevation face. The revised drawing is available for download from our web site www.haarchitects.com; then click on the “Shortcut to Plan Room” link.
- 3.12 Sheet E4.1
An additional intercom station (Item #21) shall be added to the West side of the sales counter. The intercom station shown on the East side shall remain. The exact location of each of the two intercom speakers shall be coordinated with the Owner prior to installation.
- 3.13 Sheet QA1.1
The detail bubble around the Caribou Coffee area is blank. This detail shall reference A / CFS1.2.
- 3.14 Sheet QA4.0
Multiple detail symbols are indicated as black circles. This sheet has been updated to clarify the detail numbers accordingly. The revised drawing is available for download from our web site www.haarchitects.com; then click on the “Shortcut to Plan Room” link.
- 3.15 Sheet QA4.1
- a. Detail 4, has a section marker shaded black. This reference has been updated to “4a/QA4.1”.
 - b. Detail 20, has a shaded black section marker. This reference has been updated to “20A/QA4.1”.
- 3.16 Sheet QK2.1
The walk-in cooler and the wire rack elevations have multiple shaded black symbols. All of these black symbols shall be changed to be equipment item “505.”
- 3.17 Sheet QK3.0
Item 326 - 4 compartment sink. Revised to “provided and installed by G.C.”
Item 315 - Prep Sink. Revised to “provided and installed by G.C.”
Item 305 - Handsink. Revised to “provided and installed by G.C.”
- 3.18 Sheet QID3.1
Detail “9” shows a black rectangle pointing towards the base tile which has been clarified as finish “MB01”.

END OF ADDENDUM